

# SCISSOR LIFTS - BATTERY

## 8 M SCISSOR

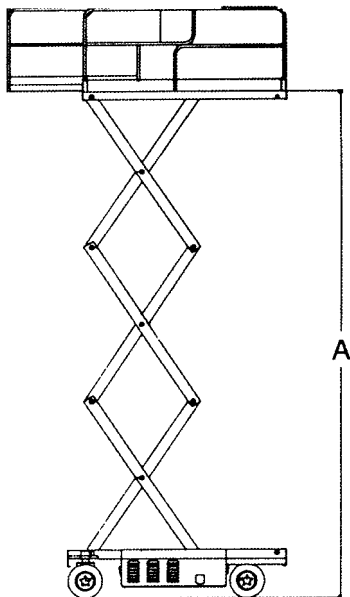
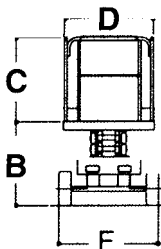
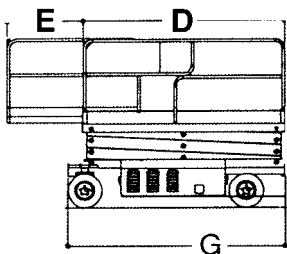

	Working Height	.....	.7.60m
A	Platform Height - Elevated	.....	.6.10m
B	Platform Height - Lowered	.....	.0.97m
C	Platform Railing Height	.....	.1.00m
D	Platform Dimensions	.....	.1.07m x 2.39m
E	Platform Extension	.....	.0.91m
F	Overall Width	.....	.1.17m
G	Overall Length	.....	.2.59m
	Platform Capacity	.....	.454kg
	Capacity on Deck Extension	.....	.113kg
	Maximum Drive Height	.....	.Full Height
	Non-Marking Tyres	.....	.Yes
	Gross Weight (Approx)	.....	.1664kg